

RANGE 5 TOWN 6 SECTION 13 MONROE TOWNSHIP PLAT NO.7

SCALE: 1" = 400'

SURVEYS

**S.E. QUARTER**  
SUR. VOL. 3, PG. 331  
SUR. VOL. 17, PG. 56  
SUR. VOL. 17, PG. 94  
LND. 56-105

**N.E. QUARTER**  
SUR. VOL. 11, PG. 58  
SUR. VOL. 17, PG. 57  
SUR. VOL. 32, PG. 141

**N.W. QUARTER**  
LND. 4-216  
LND. 22-2  
LND. 24-33  
LND. 25-107  
LND. 29-18  
LND. 42-122  
LND. 54-151  
LND. 54-172  
LND. 56-95  
LND. 56-142

**S.W. QUARTER**  
SUR. VOL. 10, PG. 170  
SUR. VOL. 10, PG. 173  
SUR. VOL. 10, PG. 175  
SUR. VOL. 32, PG. 28  
SUR. VOL. 35, PG. 154  
LND. 38-126  
LND. 38-135  
LND. 38-25  
LND. 42-68  
LND. 42-132  
LND. 48-39

KESSLER-COWLESVILLE RD. NO. 40 38' R/W

Tyrone E. & Candi S. Hissong  
D.B. 651-389  
51.899 AC.  
G13-000001  
SUR. VOL. 4 PG. 216  
SUR. VOL. 29 PG. 18

Tyrone & Candi Hissong  
D.B. 675-819  
69.493 AC.  
LAND SUR. 42-122  
(39.523 AC.)  
TIPP SCHOOL DIST

77.041 AC.  
01100  
G12-011300

Wilma J. Mohr Farms  
D.B. 756-433 LTD

21.165 AC.  
LND. 54-172  
54-151

Shawn M. Ronicker & Janet M. Ronicker  
D.B. 433-69

GARY A. & TERRY GERBER  
D.B. 161-711

LCS 4LR PARKER  
D.B. 20110R-06302

R. Scott Knite & W. J. R. Knite  
D.B. 2050R-14028

Nashville Seed Co.  
2018OR-09405

J.F. Hendrix  
D.B. 707-884

Jeffrey D. & Kimberly A. Wheeler  
2020OR-16197

Joseph J. & Lisa M. Allison  
D.B. 2018OR-01717

Harold K. & Amber L. Hamilton  
(0.001 AC. TOTAL)  
D.B. 883-346

Joseph F. Payton, Jr.  
Carolyn J. Payton  
D.B. 682-776  
15.322 AC.  
SUR. VOL. 10, PG. 170  
G13-000500

Charles H. Elliott  
D.B. 490-741  
53.586 AC.  
SUR. VOL. 10, PG. 175  
G13-001100

Marcus R. Pratt  
D.B. 645-823  
15.000 AC.  
LND. 38-126

Dennis K. McCurdy & Katherine C. Smith  
D.B. 663-159  
15.396 AC.  
LND. 38-126

Wilma Mohr Farms Ltd  
40.023 AC.  
D.B. 756-433  
(LND. 3-331)  
G12-011400  
009105

Tyrone E. & Candi S. Hissong  
2015OR-07128  
54.002 AC.  
LND. 56-105  
LND. 3-331

C. Elliott, Trustee  
D.B. 490-741  
48.497 AC.  
LND. 56-105  
LND. 3-331

Sierra Luna Land Company  
2015OR-11634, 11633  
974.58'  
G12-011600  
10.190 AC.  
LND. 56-105  
LND. 3-331

SEC. 12  
SEC. 14 UNION TWP.  
SEC. 24  
MILTON UNION SCHOOL DIST.  
TIPP CITY SCHOOL DIST.  
MILTON UNION SCHOOL DIST.  
TIPP CITY SCHOOL DIST.

NASHVILLE RD. NO. 41 60' R/W  
WORLEY RD. NO. 145 36' R/W

STATE ROUTE 571  
60' R/W

SEE DETAIL AT LEFT

REVISIONS:  
1. 8/25/15  
AM

SEE UNION TWP 5-14, T-6, R-5

1/307 AC. LND. 10-173 - 00200-1  
W.M.L. & R.S. CHRISTIAN  
D.B. 654-227

1/311 AC. LND. 10-178 - 00300-1  
R.L. JENDRUSIK  
D.B. 794-760

224.97' 2,368 AC. LND. 10-173 - 00400-1  
A.B. STEPHENS  
D.B. 725-489

318.66' 3,406 AC. LND. 10-173 - 00500-1  
T.J. ARANDEL  
D.B. 659-42  
D.B. 728-210

53.586 AC. LND. 10-175

0.035 AC. LND. 38-17

0.217 AC. LND. 10-175

CH Elliott  
D.B. 490-741

SCALE: 1" = 200'

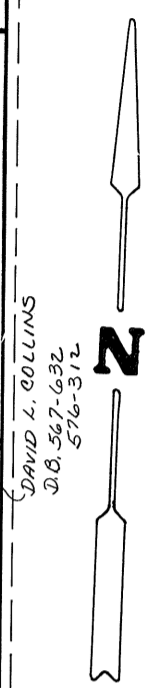

SEC. 18  
SEC. 14  
SEC. 13  
SEC. 12  
SEC. 11  
SEC. 10  
SEC. 9  
SEC. 8  
SEC. 7  
SEC. 6  
SEC. 5  
SEC. 4  
SEC. 3  
SEC. 2  
SEC. 1