

BETHEL TOWNSHIP MIAMI COUNTY, OHIO KEY MAP

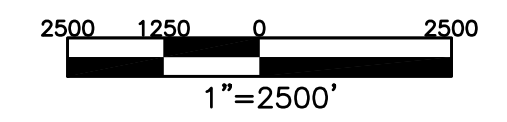

ABBREVIATION LEGEND	
	= U.S. ROAD
	= STATE ROAD
	= COUNTY ROAD
T-183	= TOWNSHIP ROAD
	= INCORPORATED AREAS

- SECTION 5**
 1. HEILMAN DR.
 2. WESTLAND DR.
 3. EASTLAND DR.
 4. OVERLOOK DR.
- SECTION 7**
 1. WEST HASKETT LANE
 2. EAST HASKETT LANE
- SECTION 10**
 1. BETHELVILLE DRIVE
 2. BEAUTONIA AVE.
- SECTION 14**
 1. WONDER WAY
- SECTION 21**
 1. WINTERHILL CT.
 2. WINDHAM RD.
 3. NEWBURY RD.
- SECTION 25**
 1. JULIE CT.
 2. GIBSON DR.
 3. LISA DRIVE
 4. DINSMORE DR.
 5. SHROYER DR.

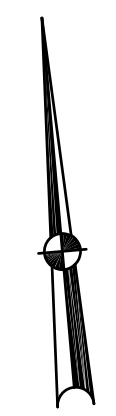
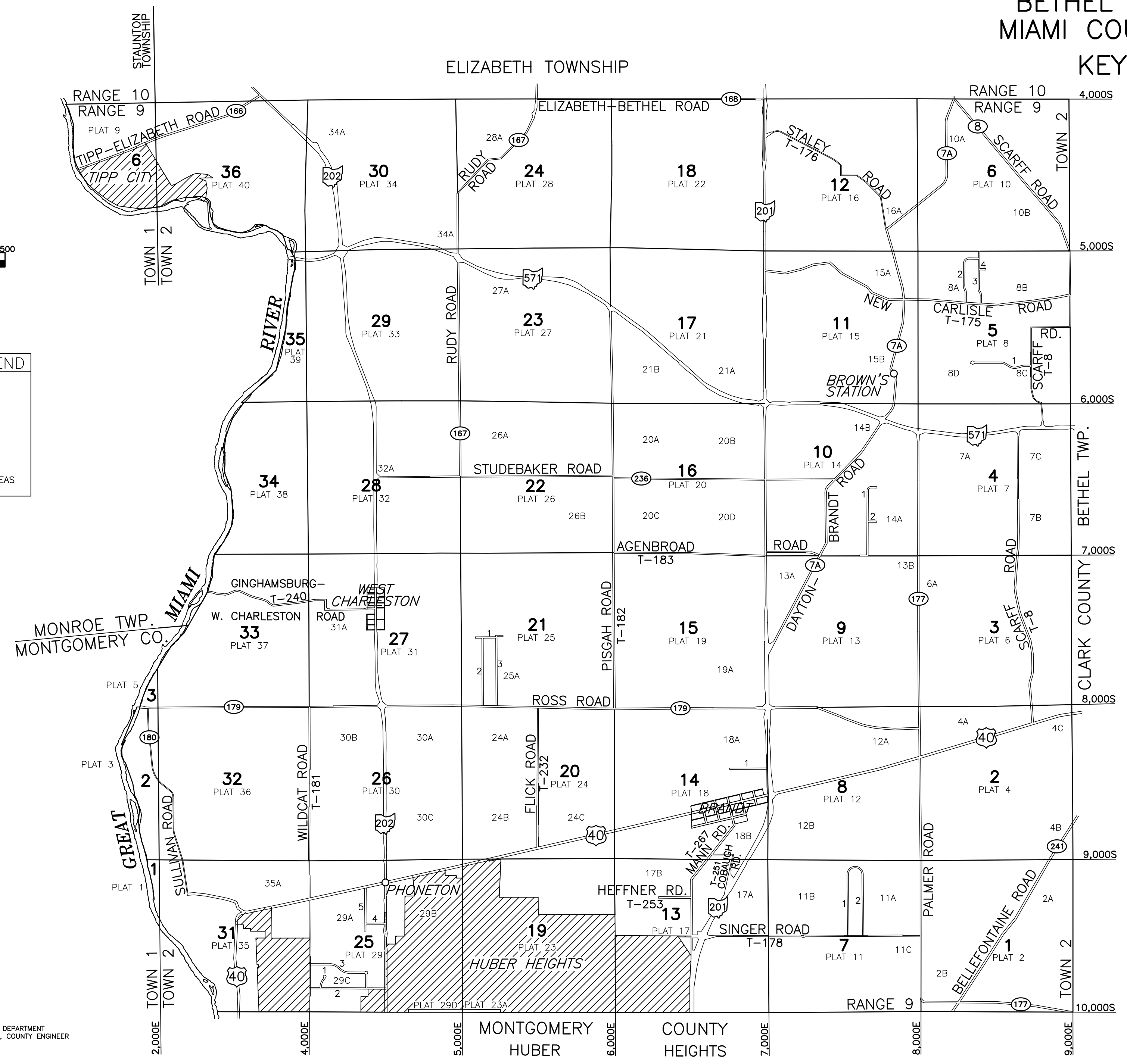

PREPARED BY: MIAMI COUNTY ENGINEER'S MAP DEPARTMENT
 PAUL P. HUELSKAMP, P.E., P.S., COUNTY ENGINEER
 DATE: JUNE 9, 2016 MB
 REVISED: JUNE 9, 2016 MB